

## IF THE PUMP CEASES TO FUNCTION, CHECK FOLLOWING:

- Check the switch/circuit breaker and try another socket in order to check that the pump has electricity supply. N.B.: Always disconnect the power before handling the pump.
- Check that the hoses or the outflow are not blocked. A garden hose can be used to flush out any algae.
- Check the filter inlet and clear possible dirt.
- Remove the pump inlet in order to come to the rotor. Check that it is not broken or blocked.

If the pump is maintained monthly the length of life will be extended.

N.B.: Ensure that a part of the cable hangs lower than the socket. This prevents water running down the cable into the socket.

## WINTER MONTHS

- Protect your pump against frost.
- Take your pump from the water for the frost period.
- Clean the pump when necessary as previously described in the directions for use.
- Keep your pump, for example, in a bucket of water or a frost-free place so they can freeze or dry out.

## LIMITED WARRANTY:

This product is guaranteed for a period of 12 months from date of purchase for material or manufacturing defects. In case it is submitted for repair the pump must be with the original receipt. Guarantee consists in guaranteed substitution of defective parts. Guarantee is considered to void in case of improper use, or damages caused by improper handling or negligence on the part of the buyer. All equipment must be sent postage paid



## OWNER'S MANUAL FP-SERIES FOUNTAIN PUMPS

### Introduction

The pumps are carefully inspected and tested to ensure both safety and operating performance. However, failure to follow the instructions and warnings in this manual may result in pump's damage and/or serious injury. Be sure to read and save this manual for future reference.



### Important!

The plug and the socket must not come in to contact with the water. If there is a problem with electrical supply to the pump resulting in its failure to operate, ensure it is checked and repaired if necessary by a qualified electrician. Ensure the electrical cable loops below the electrical supply to form a "Drip Loop". The pump must be fully immersed in water when it is used, since dry running can cause it to fail. Before the turning on the power ensure the pump is totally immersed in water. Ensure that the electrical cable does not lie across pathways so that people do not trip on them. Never leave the pump unattended during use if there are children nearby. Unplug the mains power when the pump is not in use. Product is designed for use indoors or outdoors. The cable cannot be replaced. If the cable is damaged the device must be discarded.

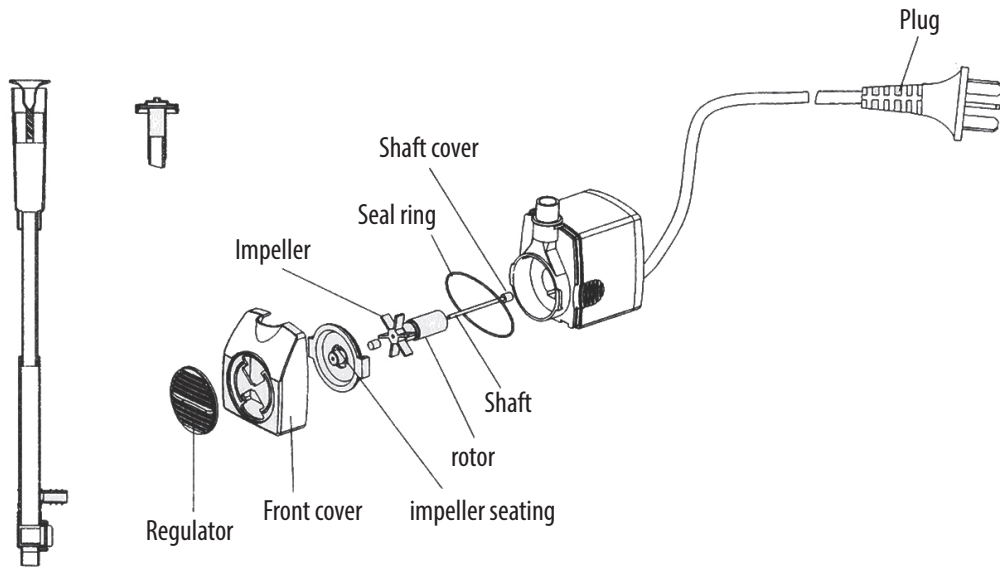

### Maintainance

Use only fresh water in this pump.

Little maintainance is necessary if the pump is used according to the instructions in this manual. If dirt builds up in the intake, rinse using running water but remember to always unplug from the power first. A 30mA (or less) Residual Current Device (RCD) must be fitted to the mains supply.

### Warning!

- Never connect to a power supply with different voltage and current than that stated on the pump's label.
- Never pump flammable fluids through the pump.
- National electrical regulations require that a ground fault circuit interrupter (GFCI) is used in direct connection to equipment that is used in water. See your electrical supplies outlet for this device
- Do not use the pump in waters that exceed 30°.

### CAUTION!

The power must be disconnected before the pump is handled.  
 The pump must be entirely immersed in water when it is used.  
 The pump must never be lifted by the cable.  
 Hot fluid must never be pumped (maximum 30° C).  
 Only fresh water may be pumped.  
 The pump must not be operated without the supplied pump cage  
 Only turn on mains power once pump is in position

### USE

A clogged or dirty intake will put a strain on the motor and greatly reduce the pump's performance. If the base on which the pump is to be stood is very dirty, raising the pump slightly will reduce the amount of debris surrounding the intake of the pump. If decreased flow is desired this can be adjusted with the control on the side of the pump or through limiting the outflow.  
 The pump should not be used when it is not immersed in water since it can be damaged.  
 Only connect the power once immersed in water. When first installed there may be air trapped in the pump and tubing, this can be dispersed by turning the pump on and off several times

### MAINTENANCE

To clean the pump remove the impellor housing and impellor. Use clean water and a small brush to remove debris. Never use harsh cleaners or chemical solutions for cleaning the pump (this may cause permanent damage)

**OBSERVE:** It is not possible to remove the axle.